

BUILDING ZONE MAP OF THE INCORPORATED VILLAGE OF GREAT NECK ESTATES NASSAU COUNTY N. Y.

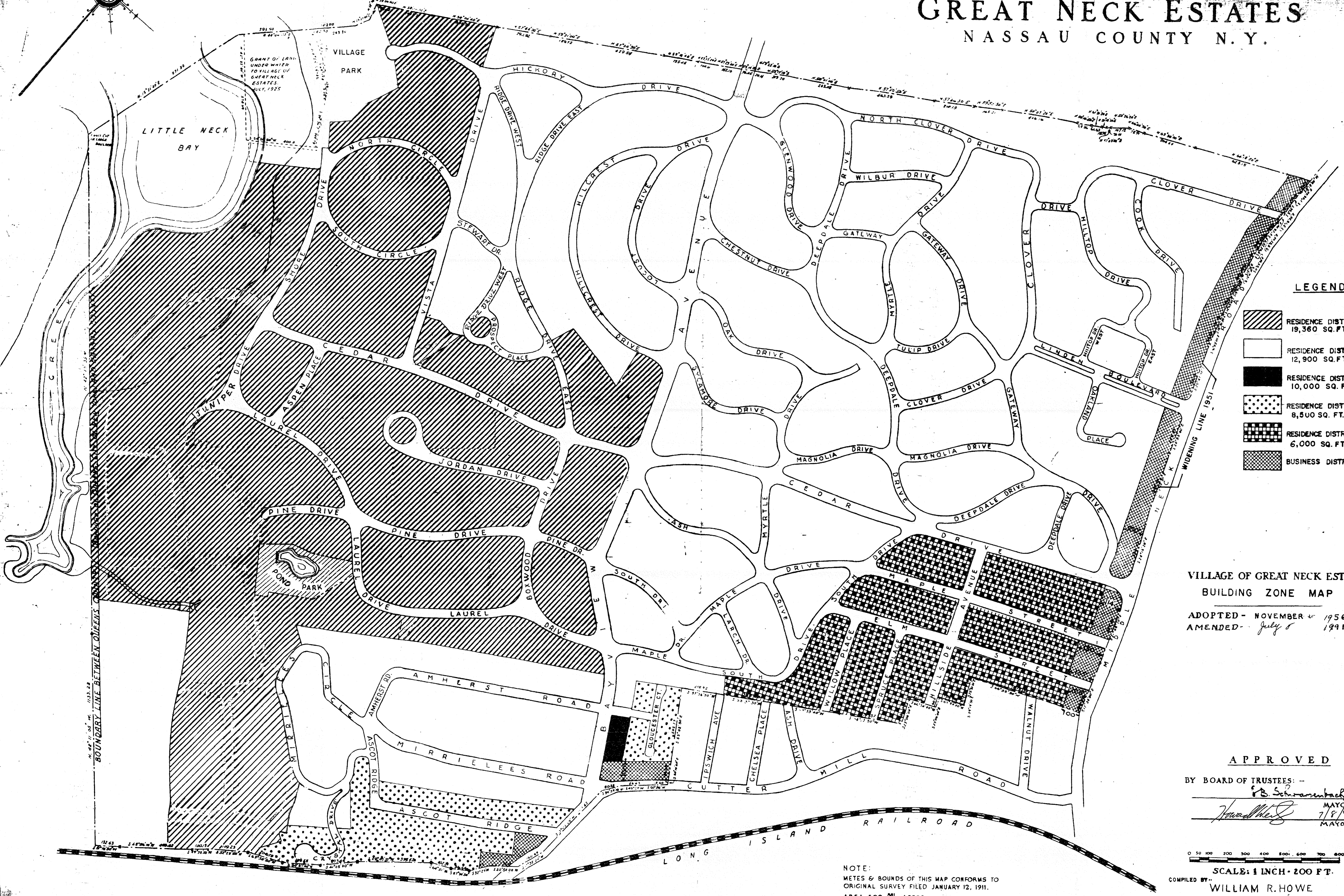
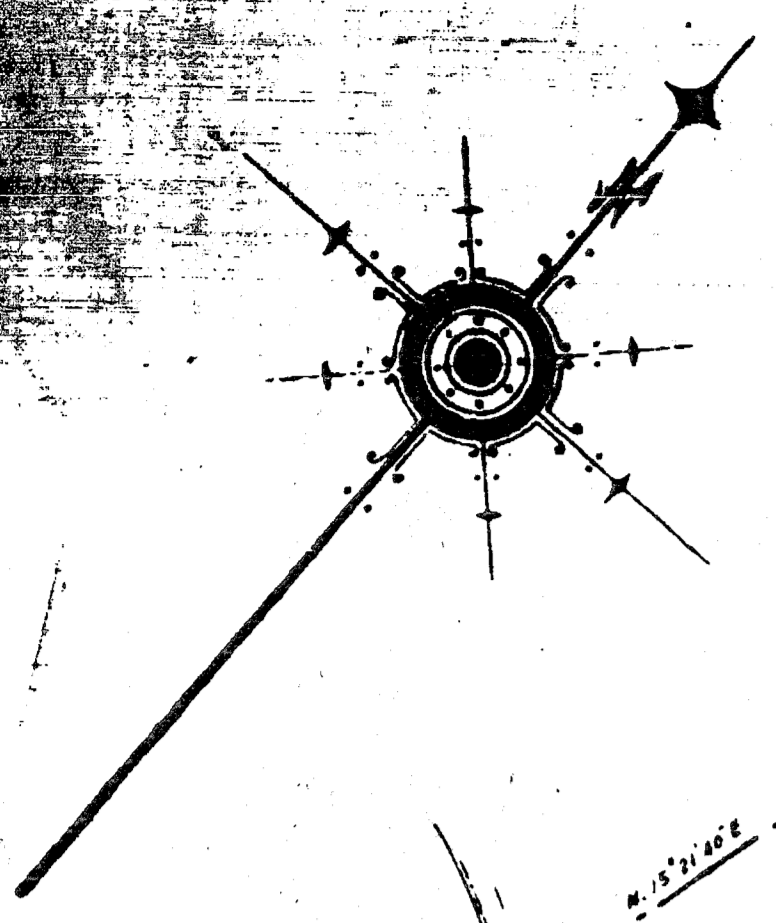

LEGEND

- RESIDENCE DISTRICT "A"
19,360 SQ. FT.
- RESIDENCE DISTRICT "B"
12,900 SQ. FT.
- RESIDENCE DISTRICT "B-B"
10,000 SQ. FT.
- RESIDENCE DISTRICT "B-C"
8,500 SQ. FT.
- RESIDENCE DISTRICT "C"
6,000 SQ. FT.
- BUSINESS DISTRICT "D"

VILLAGE OF GREAT NECK ESTATES
BUILDING ZONE MAP

ADOPTED - NOVEMBER 1956
AMENDED - July 1991

APPROVED

BY BOARD OF TRUSTEES: -

MAYOR
7/8/91
MAYOR

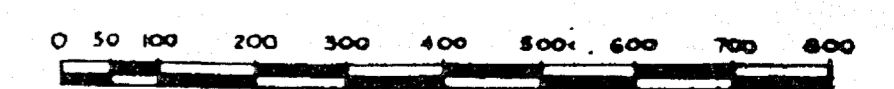

SCALE: 1 INCH = 200 FT.

COMPILED BY:
WILLIAM R. HOWE
 VILLAGE ENGINEER

NOTE:
 METES & BOUNDS OF THIS MAP CONFORMS TO
 ORIGINAL SURVEY FILED JANUARY 12, 1911.
 AREA 509 ACRES.

BOUNDARY LINE BETWEEN DISTRICTS